

ULAB 2024 ACCESSIBILITY MAP

all locations are ground floor / wheelchair accessible, and equipped with an elevator

ADDRESSES

Main conference location

Arts Rd, Falmer, Brighton BN1 9RG

- presentations in Silverstone 121 & 309
- lunch in Silverstone 317

Friday social

Room 76, Falmer, Brighton BN1 9QF

- ground floor

Conference dinner / social

The Font, Union St, Brighton and Hove,
Brighton BN1 1HA

-> for a conference map
& complete sussex university map

Access

- Primary pedestrian route
- Other pedestrian route
- Road with pavement
- Cycle route
- Step-free route
- Entrance (wheelchair accessible unless wheelchair-user entrance label on building)
- Wheelchair-user entrance
- Steep slope (gradient)
- Steps (number of steps)
- Lift

Transport

- Bus stop
- Car park
- Railway station
- Number of disabled parking spaces

- ### Main buildings
- | | |
|---|--|
| D3 Accelerator Building | D4 Hastings |
| E3 Aisin Seiki | B7 Health Centre |
| B4 Arts A | A4 Institute of Development Studies (IDS) |
| B4 Arts A Lecture Theatres | E4 John Clifford West |
| B4 Arts B | C3 John Maynard Smith (JMS) |
| B5 Arts C | B5 Jubilee |
| C4 Arundel | B5 Jubilee Lecture Theatre |
| E3 Ashdown House | (A2) The Keep (off map) |
| A3 Attenborough Centre for the Creative Arts (ACCA) | A4 Library |
| D3 Biomedical Research Facility | B3 Meeting House |
| C5 Boiler House | D2 Old Ancillary Building |
| C6 Bramber House | C3 Pevensey I |
| D2 BSMS Research | C3 Pevensey II |
| C2 BSMS Teaching | D3 Pevensey III |
| C4 Chichester I | C4 Richmond |
| C4 Chichester II | C4 Shawcross |
| D4 Chichester III | B5 Silverstone |
| C4 Chichester Lecture Theatre | A2 Sport Centre |
| E4 Clinical Imaging Sciences Centre (CISC) | E4 Sussex Health Outcomes Research and Education in Cancer (SHORE-C) |
| D2 CRPC | C2 Sussex House |
| E2 Co-operative Childcare | E2 Sussex Innovation Centre |
| B6 Essex House | C6 Student Centre |
| B3 Falmer House | E3 Thermo-Fluid Mechanics Research Centre (TFMRC) |
| F5 Falmer Sports Complex | E4 Trafford Centre |
| E3 Freeman | B6 York House |
| D4 Friston | |
| C5 Fulton | |
| D3 Genome Damage and Stability Centre (GDSC) | |

Facilities

All academic buildings have toilets

Café Restaurant Bar Shop ATM Post Office Health/First Aid Launderette Information point Shower/changing room Pharmacy Optician 24-hour security point/reception in or outside building

Name of residence Accommodation Area under development

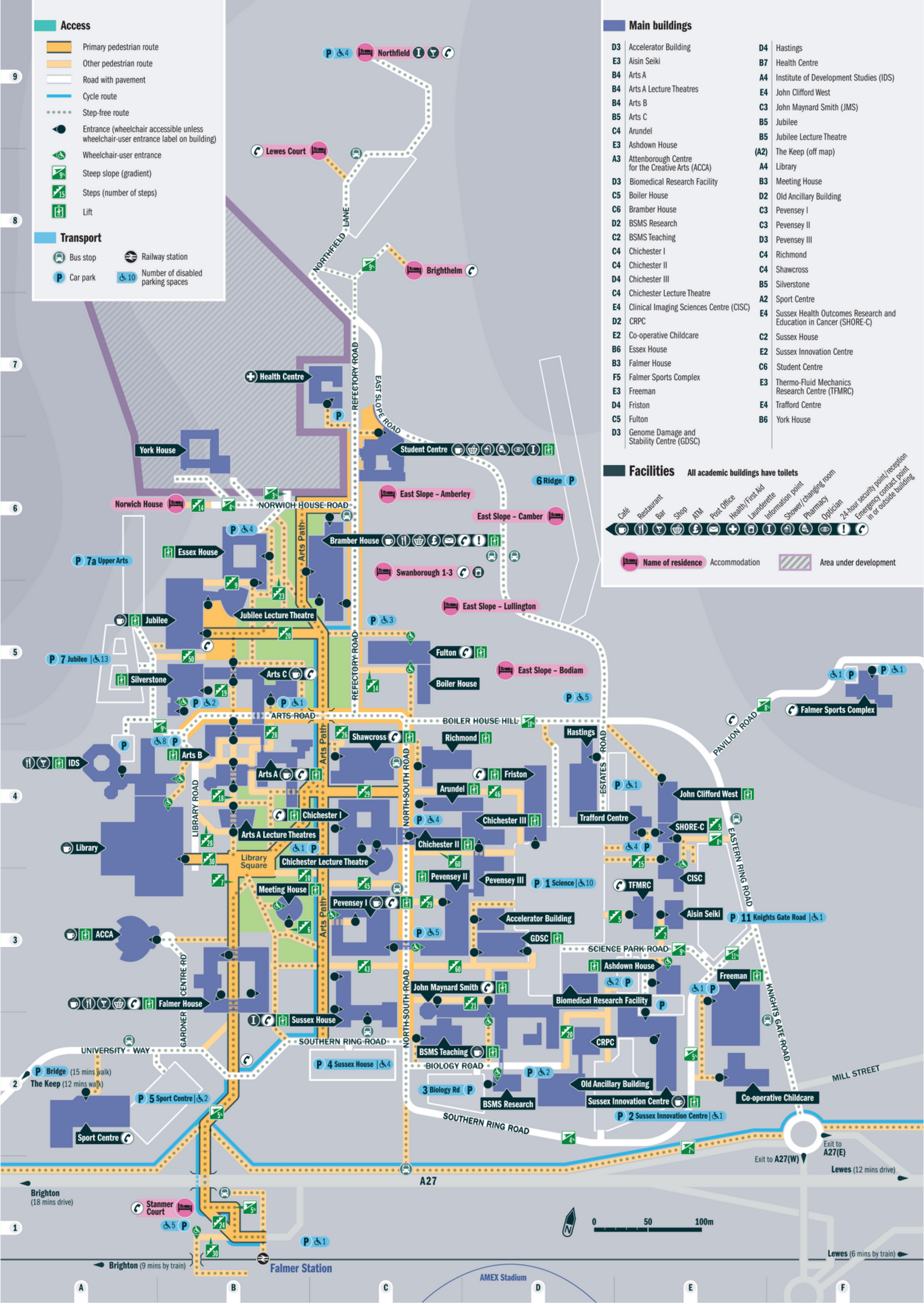

Access

- Primary pedestrian route
- Other pedestrian route
- Road with pavement
- Cycle route
- Step-free route**
- Entrance (wheelchair accessible unless wheelchair-user entrance label on building)
- Wheelchair-user entrance
- Steep slope (gradient)
- Steps (number of steps)
- Lift

Transport

- Bus stop
- Railway station
- Car park
- Number of disabled parking spaces

STEP FREE ROUTE (DOTTED LINE)

- Main buildings**
- | | |
|---|--|
| D3 Accelerator Building | D4 Hastings |
| E3 Aisin Seiki | B7 Health Centre |
| B4 Arts A | A4 Institute of Development Studies (IDS) |
| B4 Arts A Lecture Theatres | E4 John Clifford West |
| Arts B | C3 John Maynard Smith (JMS) |
| Arts C | B5 Jubilee |
| C4 Arundel | B5 Jubilee Lecture Theatre |
| E3 Ashdown House | (A2) The Keep (off map) |
| A3 Attenborough Centre for the Creative Arts (ACCA) | A4 Library |
| D3 Biomedical Research Facility | B3 Meeting House |
| C5 Boiler House | D2 Old Ancillary Building |
| C6 Bramber House | C3 Pevensey I |
| D2 BSMS Research | C3 Pevensey II |
| C2 BSMS Teaching | D3 Pevensey III |
| C4 Chichester I | C4 Richmond |
| C4 Chichester II | C4 Shawcross |
| C4 Chichester III | B5 Silverstone |
| C4 Chichester Lecture Theatre | A2 Sport Centre |
| E4 Clinical Imaging Sciences Centre (CISC) | E4 Sussex Health Outcomes Research and Education in Cancer (SHORE-C) |
| D2 CRPC | C2 Sussex House |
| E2 Co-operative Childcare | E2 Sussex Innovation Centre |
| B6 Essex House | C6 Student Centre |
| B3 Falmer House | E3 Thermo-Fluid Mechanics Research Centre (TFMRC) |
| F5 Falmer Sports Complex | E4 Trafford Centre |
| E3 Freeman | B6 York House |
| D4 Friston | |
| C5 Fulton | |
| D3 Genome Damage and Stability Centre (GDSC) | |

Facilities All academic buildings have toilets

Café Restaurant Bar Shop ATM Post Office Health/First Aid Laundrette Information point Shower/changing room Pharmacy Optician 24-hour security point/reception Emergency contact point in or outside building

Name of residence Accommodation Area under development

SILVERSTONE BUILDING: MAIN LOCATION OF THE CONFERENCE

ARTS RD, FALMER, BRIGHTON BN1 9RG

- BUILDING HAS A LIFT!
- WE'LL BE ON FLOORS 1&3
- PRESENTATIONS IN SILVERSTONE 121 & 309
- LUNCH IN SILVERSTONE 317.

FALMER HOUSE: FRIDAY SOCIAL LOCATION

ROOM 76, FALMER, BRIGHTON BN1 9QF

- GROUND FLOOR

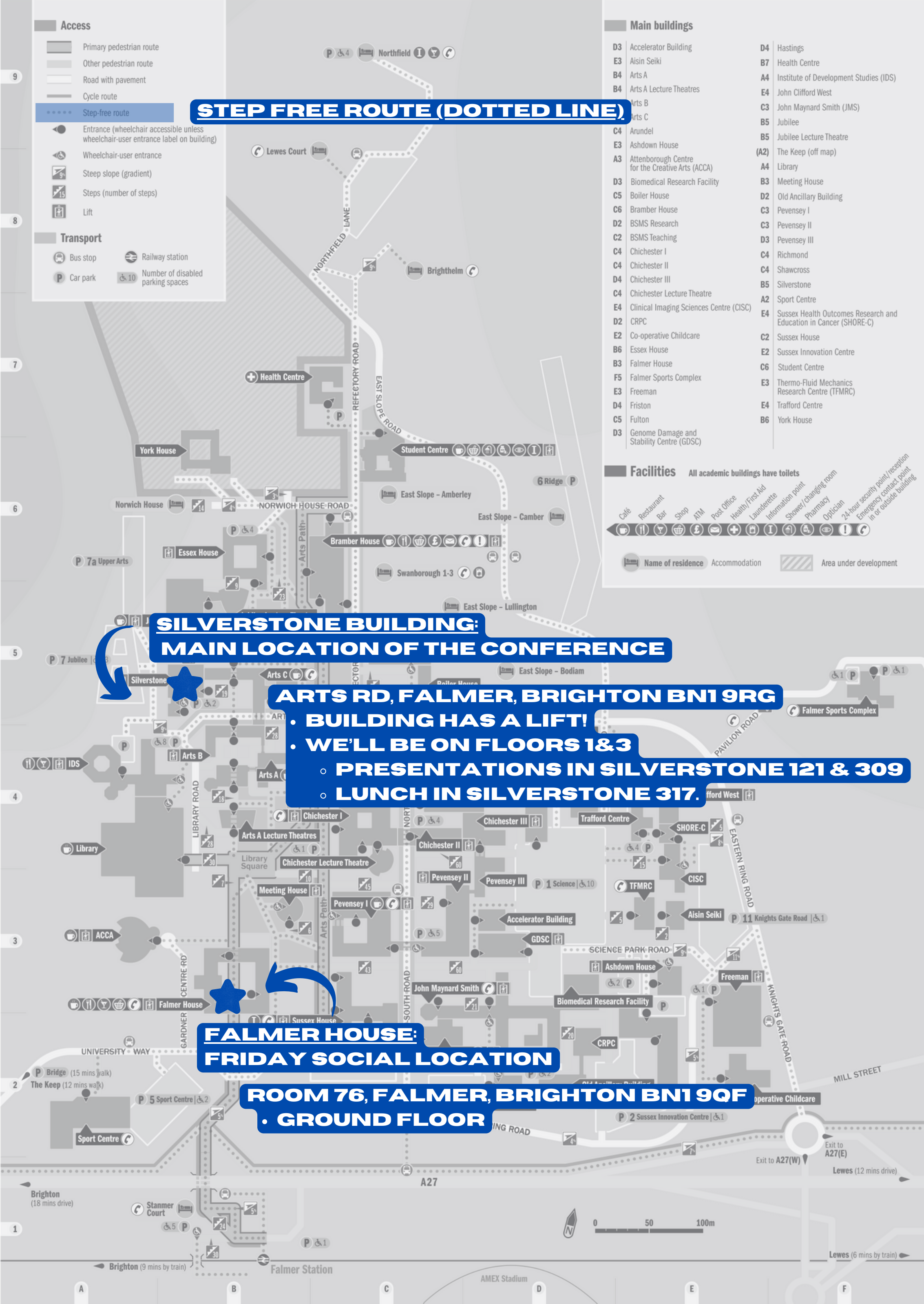

SILVERSTONE BUILDING

**LEVEL 1
(GROUND
FLOOR)**

LIFT

**ROOM 121
PRESENTATIONS
IN THIS ROOM**

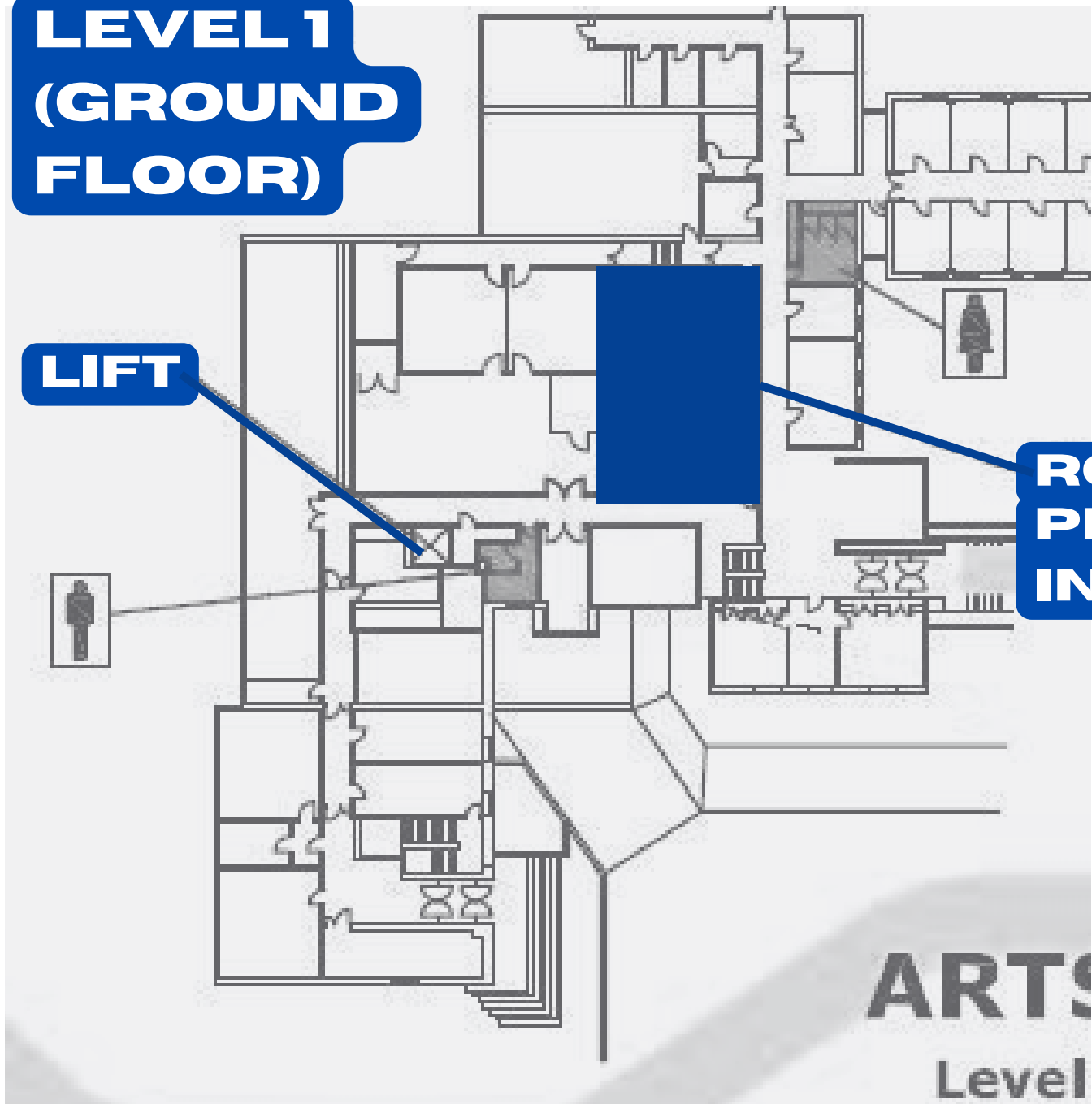

LEVEL 3

**ROOM 317
(LUNCH!)**

**ROOM 309
PRESENTATIONS**

LIFT

